

# RENOVA

## 1RSCB 45-65

Performance curve for Vacuum pump

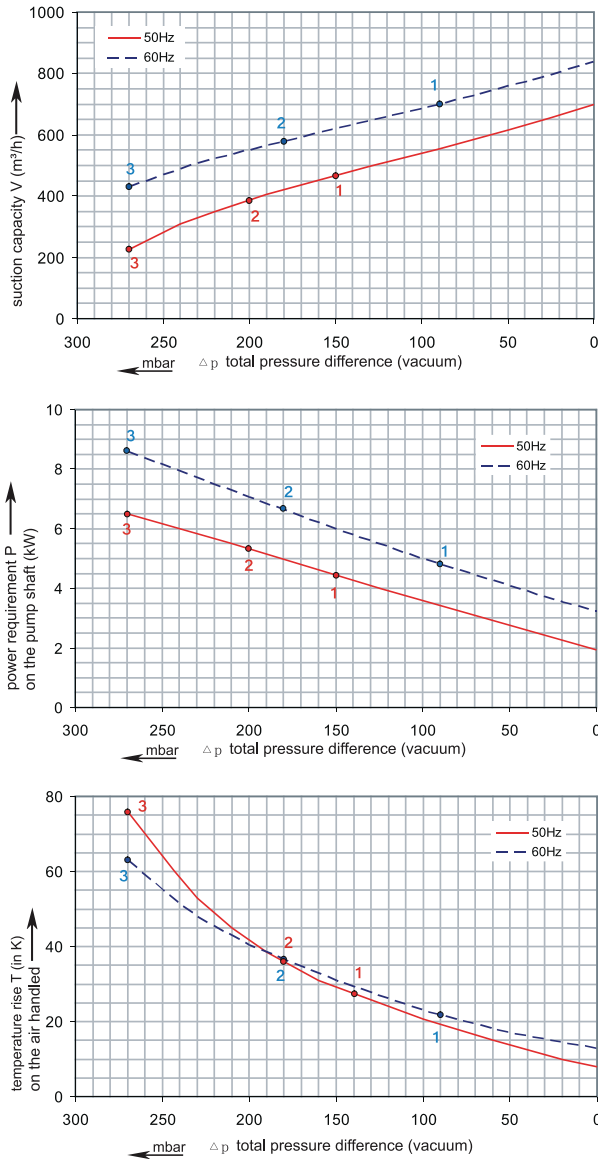

## 1RSCB 45-65

Performance curve for Compressor

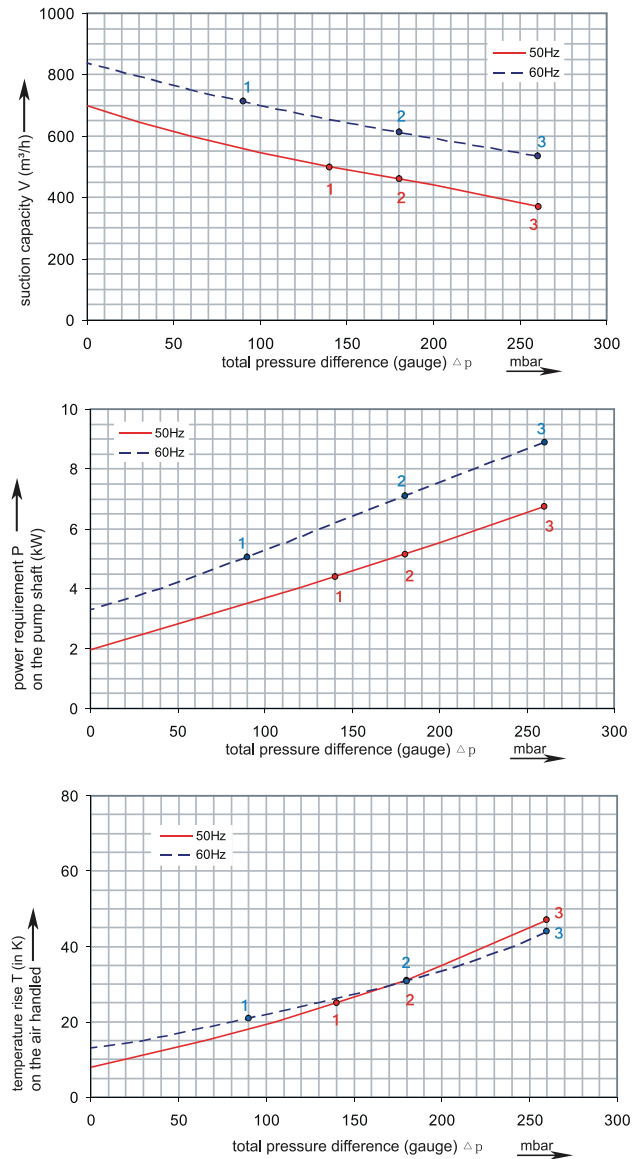

The performance curves are based on air at a temperature of 15 °C and an atmospheric pressure of 1013 mbar with a tolerance of +/- 10 %. The total pressure differences are valid for suction and ambient temperatures up to 25 °C. For other conditions please confer with us.

Each RSC type can be applied both as vacuum pump and compressor in continuous operation over the total stated performance curve range. The motors are available as standard for the input voltage range of 50 and 60 Hz and for protection category IP 55.

# RENOVA

## 1RSCB 45-65

Curve No.	Model	Freq. (Hz)	Power (KW)	Max. Flow (m3/h)	Max. Vacuum (mbar)	Max. Pressure (mbar)	Voltage (V)	Current (A)	Inlet / Outlet	Noise (dBA)	Weight (Kg)
1	1RSCB45/65 4.0T	50	4.0	700	-150	140	345-415Δ / 600-690Y	9.5Δ / 5.5Y	G 2½"	70	57
		60	4.6	840	-90	90	380-480Δ / 660-720Y	9.5Δ / 5.5Y		74	
2	1RSCB45/65 5.5T	50	5.5	700	-200	190	345-415Δ / 600-690Y	13.3Δ / 7.7Y	G 2½"	70	66
		60	6.3	840	-180	180	380-480Δ / 660-720Y	13.3Δ / 7.7Y		74	
3	1RSCB45/65 7.5T	50	7.5	700	-270	260	345-415Δ / 600-690Y	16.7Δ / 9.6Y	G 2½"	70	69
		60	8.6	840	-270	260	380-480Δ / 660-720Y	17.3Δ / 10.0Y		74	

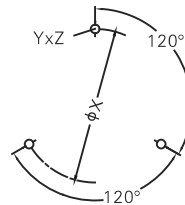
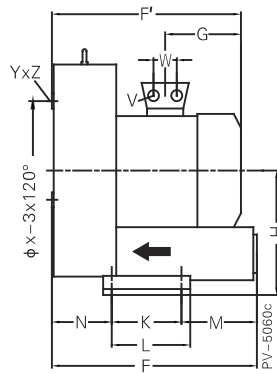
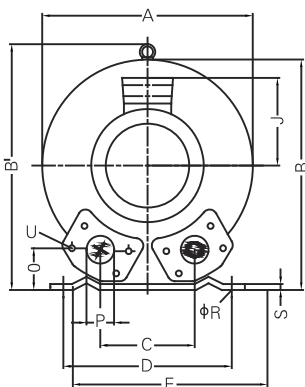
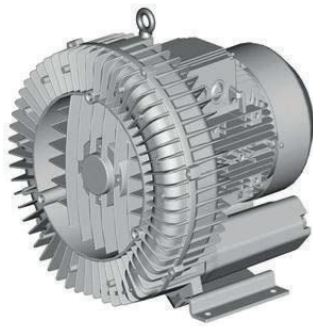

Model	A	B	C	D	E	F'	G	H	J	K	L	M	N	O	ØP
1RSCB45/65 4.0T	451	461	152	356	394	466	230	240	148	170	217	140	164	65	2½"
1RSCB45/65 5.5T	451	461	152	356	394	492	247	240	167	170	217	140	164	65	2½"
1RSCB45/65 7.5T	451	461	152	356	394	492	247	240	167	170	217	140	164	65	2½"